



DESIGNED TO BE DIFFERENT BUILT TO BE BETTER



DESIGN GENESIS

The SafeTCase was created as a response to our experience of working in DoD aviation facilities for the past 20 years: the method of supplying shore power to crafts requiring specific electrical current (such as 400Hz or 270 DC) was outdated, non in compliance with current UFC specifications and widely accepted electrical safety standards.

We have also been called to fix broken electrical cabinets when cords have torn the cabinet away from the wall and have seen, first hand, the impact this has on the operational environment that is so critical to our client's and Country's mission of remaining ever-ready.

ENGINEERED FOR SAFETY, RELIABILITY & ACCESSIBILITY.

SAFETY

The SafeTCase was designed to provide immediate and significant improvements to the life safety environments for users and facilities where it is installed.

Users are able to access and provide electrical power without exposing themselves to electrical current. The need for Arc Flash PPE is eliminated while allowing facilities to meet regulations set forth by OSHA, NFPA, NEC, and the Unified Facilities Criteria (UFC).

RELIABILITY

SafeTcases are designed to eliminate moving parts or mechanical systems that were necessary in legacy electrical boxes.

This benefits the users and facilities by providing equipment that is low-maintenance and reliable, while improving upon the previous design that proved to wear out - creating safety and operational burdens.

ACCESSIBILITY

Components of the SafeTCase are carefully specified to industry standards components that are widely available.

This intentional design allows qualified electricians to easily diagnose any SafeTCase and source replacement parts with readily available parts.

BENEFITS FOR REAL WORLD UTILITY



FULL CONTAINMENT & PERSONAL PROTECTIVE EQUIPMENT (PPE)

A fully contained system provides a distinct safety benefit to users and facilities. When users are not required to open the electrical cabinet to make a connection to power, they do not need to put on an Arc Flash PPE. This benefits facilities by allowing users to access and provide power to aviation crafts more quickly, efficiently, and safely.



THE PLUG PROBLEM.....SOLVED

AN OPPORTUNITY FOR IMPROVEMENT...DELIVERED

The SafeTCase plug housing allows for an external connection to a variety of plugs, including the NATO Anderson Plug with the UFC required safety bypass circuits (short pins). This important safety feature prevents power delivery until the plug is fully seated into the plug housing.

The 45 Degree plug housing is designed to the cable to detach safely onto the ground in the event of a tear-away. This intentional design prevents damage to the electrical cabinet and connected equipment.



VALUE FOR YOUR FACILITY

EASY TO USE MEANS EASY TO TEACH

Simple push button operation and fully enclosed design makes the SafeTCase easy to operate with 2 input buttons for START and STOP and indicator lights alerting users of AVAILABLE POWER.

This benefits facilities by simplifying the training process which allows for multiple users to be versed in safely providing power, improving operational efficiency, effectiveness, and mission-readiness.



TAILORED TO YOUR FACILITIES NEEDS

SafeTCases may be optioned with features to meet the needs of your users and facility.

These include LCD Display screens that report power output and variance of Voltage, Frequency (Hz), and Amperage.

Locking mechanisms can be optioned for lock & key or RFID Key FOB.

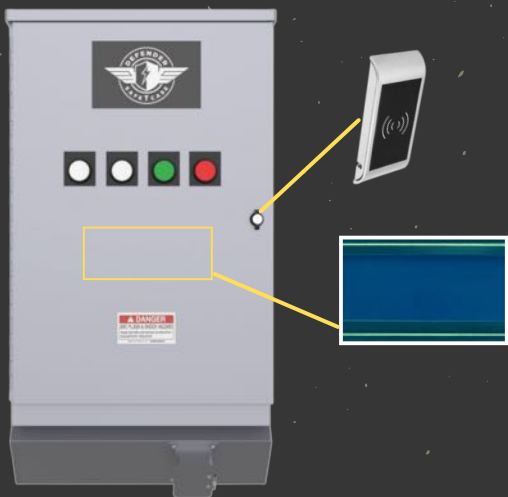

DESIGNED AND BUILT IN THE U.S.A



The SafeTCase was designed and built in the United States and meets the most rigorous privacy and quality control standards. Each SafeTCase undergoes a real-world operational simulation for heat load, electrical current testing, torque specs, switch integrity, and general operational functionality. Cases are certified before leaving our manufacturing environment in Kansas City, Missouri.

